

EARTH CHARTER YOUTH SUMMIT

REDESIGNING TOMORROW'S WORLD



Logistics Information



DATE AND VENUE

The Earth Charter Youth Summit "Redesigning Tomorrow's World: Uniting Global Youth for Climate Justice and Collective Healing — An Intercultural Call for the Earth Community" is co-convened by Earth Charter International [ECI] and Soka University of America [SUA], and will take place on July 11–13, 2026 at Soka University of America, Aliso Viejo, California, USA.

Event Address: Soka University of America
1 University Drive, Aliso Viejo, California, 92656 USA

VISA & ENTRY REQUIREMENTS

If you are traveling to the U.S. from abroad, please ensure all your migration and entry paperwork is in order before your trip. While most participants will have already secured their visa if required, [we encourage everyone to double-check](#) that their visa is still valid for the dates of travel.

Please also [be aware of any additional entry requirements](#) that may apply to your country, such as ESTA [Electronic System for Travel Authorization] for European travelers visiting under the Visa Waiver Program. Each participant is responsible for their own visa and travel documentation costs.

If you require an invitation letter for migration purposes, please email youthcoordinator@earthcharter.org



TRANSPORTATION

Nearest Airports

The two main airports serving the Soka University of America campus are:

- [John Wayne Airport – Orange County \[SNA\]](#) — the closest airport, located approximately 12 miles from campus. Travel time by taxi or rideshare is roughly 15–20 minutes. Estimated taxi fare: \$45–\$70. Taxis are available at the Ground Transportation Center on the Arrival (lower) level.
- [Los Angeles International Airport \[LAX\]](#) — located approximately 50–54 miles from campus. Travel time is approximately 1 hour depending on traffic. Estimated taxi or rideshare fare: approximately \$100 one way.

Please note that fares are estimates and may vary depending on traffic and gas prices. Always confirm the fare before your ride. Uber and Lyft are available at both airports and offer a convenient alternative to taxis. Be sure to follow airport-specific rideshare pick-up instructions upon arrival.

Organized Bus Transfer from LAX

For the convenience of participants, transportation has been arranged by SUA from Los Angeles International Airport [LAX] to the Soka University campus and back.

Pick-up - 10 July: LAX Terminal B and Terminal 7 at 10:30 AM, 12 PM, 2:30 PM, and 5 PM. We believe these will fit most of your arrivals [Look out for emails with more information!](#)

Drop-off: To be decided.

Please be 15 minutes early, so we can all leave together! The shuttle cannot wait for us.

Contact Yuya Uchida +1 (949) 339-6633 or sigs@soka.edu for additional inquiries or if your flight has been delayed and you cannot make either of the pick-up times.



MEALS

All meals during the summit will be provided at the Soka University of America Bistro. Breakfast, lunch, and dinner will be covered for all participants throughout the event. Dietary restrictions and food allergies will be considered. Your name tag will give you access to the cafeteria the following times:

- Breakfast: 7:45 AM - 9:00 AM
- Lunch: 12:30 PM - 1:30 PM
- Dinner: 5:30PM - 7:00 PM

Coffee break [10:30 - 11 AM] snacks will include a variety of sweet and savory options such as chips, chocolates, cookies, granola bars, fruits, etc. Gluten free and vegan options will be provided as well.

Participants may purchase additional food or beverages only outside of SUA campus. The closest grocery stores are within 5 to 7min car drive. Some supermarkets include Ralphs, Whole Foods, Trader Joes, and Ranch 99. Pharmacies include CVS and Walgreens. Participants will be responsible for their own transportation to these locations.

ACCOMMODATION

Participants will be hosted in residence halls 335, 365, and 375 on the beautiful campus of Soka University of America, surrounded by a 4,000-acre wilderness park in Aliso Viejo, California.

- Check-in, 10 July: 2:00 PM - 6:00 PM *all late arrivals contact sigs@soka.edu
- Check-out, 14 July: 9:00 AM

Provided: One set of linens (pillow, blanket, washcloth, hand towel, bath towel, and bathmat), toilet paper, wifi, dining, laundry rooms, pantries, water dispensers.

Not provided: toiletries, hand soap, hairdryer, additional linen sets and towels, laundry detergent.

Participants will be accommodated in individual dormitory rooms, with a shared bathroom between every two rooms. Dormitories are divided by gender. For more information about the residence halls, please click [here](#).

A \$10 penalty will be charged for any damage or loss of the key cards.

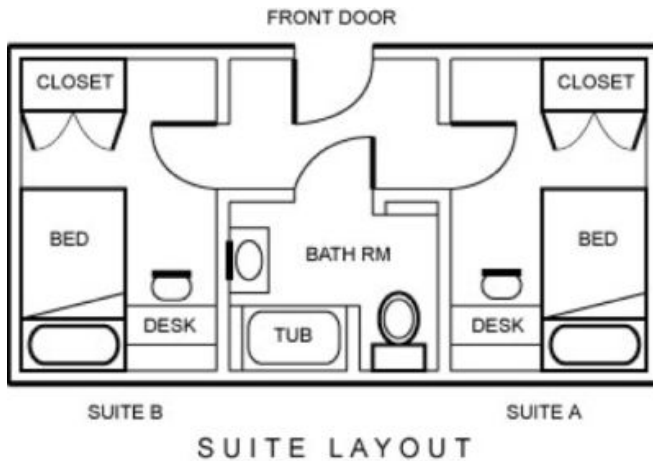

WHAT TO BRING

Weather & Climate

July in Aliso Viejo, California is warm, sunny, and dry. Temperatures range between a minimum of 59°F [15°C] and a maximum of 78°F [26°C], with plenty of sunshine and virtually no rain. Evenings can be cooler, so a light layer is recommended.

Recommended Packing List

- Casual, comfortable clothing suitable for warm daytime temperatures
- A light jacket or sweater for evenings and air-conditioned spaces
- Comfortable walking shoes for moving around campus and outdoor areas
- Sunscreen, sunglasses, and a hat for sun protection
- Reusable water bottle
- Personal toiletries and hygiene products
- Any personal medication you may need
- Adaptor/converter if traveling from outside the United States (Type A/B plugs, 120V)
- Copies of your travel documents (passport, visa, ESTA confirmation)
- Notebook and pen for sessions and workshops

We suggest that participants bring their own computers and/or electronic devices to receive and download all conference documents.

We are planning to make the Conference a paper-free event. Please bring your own notebooks and writing materials to the event. The agenda and all documents for the Conference will be shared digitally only.

Attire

The summit will have a mix of indoor sessions, workshops, and outdoor activities. We encourage smart casual attire. There is no strict dress code, but please keep in mind the professional and intercultural nature of the event.

HEALTH & SAFETY

For non-urgent medical needs, the South Coast Medical Group Urgent Care is located near the Soka campus in Aliso Viejo.

[Hoag Urgent Care Aliso Viejo](#)

[Marque Urgent Care Aliso Viejo](#)

For emergencies requiring hospital care, the nearest emergency room is:

- Providence Mission Hospital
- MemorialCare Saddleback Medical Center
- Kaiser Permanent Emergency Care

Health Insurance

All participants are [strongly encouraged to arrange their own travel and health insurance](#) prior to traveling to the United States, as medical costs in the USA can be very high. Neither Earth Charter International nor Soka University of America will be responsible for any medical expenses incurred during the event. Please carry your insurance card and policy details with you at all times.

COMMUNICATION

For any questions, assistance, or urgent matters during the summit, please do not hesitate to reach out to:

- María Sosa-Segnini: youthcoordinator@earthcharter.org
- SUA: sigs@soka.edu or +1(949) 480-4117

Social Media

We encourage all participants to capture and share their experience at the summit! Post your photos, videos, and reflections and tag us so we can share your moments with our global community:

Instagram/TikTok:

@earthcharterinternational | @earthcharteryouth | @sokauniv | @sigs_sua
#eciyoungsummit

If you prefer not to be photographed or filmed during the event, please let us know in advance.

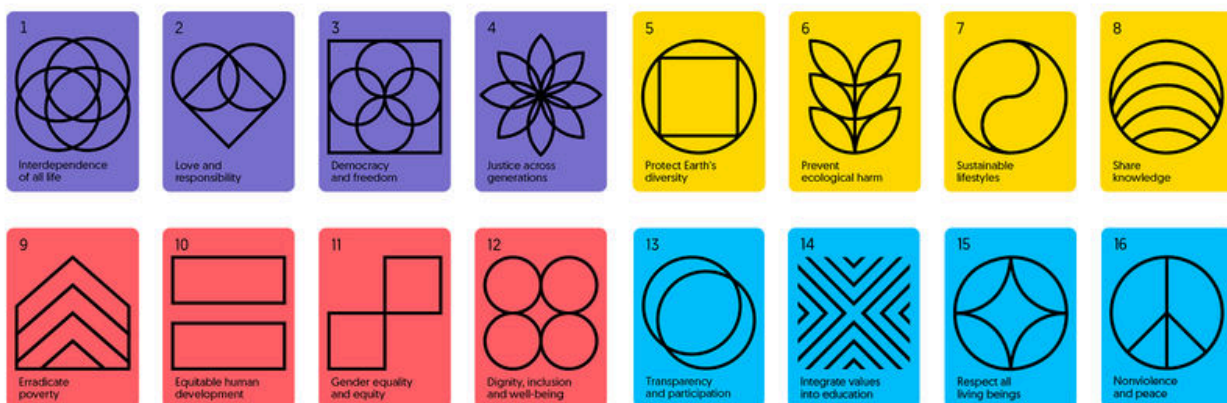

CAMPUS MAP



Residence Halls

- 19) Lokahi Residence Hall [335] + check-in
- 20) Ubuntu Residence Hall [365] + check-in
- 21) Acjachemen Residence Hall [375] + check-in

Other

- 3) Peace Lake
- 4) Founder's Hall
- 5) Soka Performing Arts Center
- 6) Maathai Hall
- 7) Pauling Hall
- 8) Curie Hall
- 10) Library
- 11) Soka Bistro

CAMPUS POLICY

Residence Hall Alcohol Policy

Students who are 21 years or older may possess and consume alcoholic beverages within their private residence hall room in Residence Hall 375. In a suite where one suitemate is over 21 and the other is under 21, alcohol should only be stored in the individual room of the suitemate who is over 21.

Alcohol is not permitted in common areas within the residence halls including, but not limited to, hallways, balconies, terraces, living rooms, computer rooms, and multi-purpose rooms, alcohol is not permitted in public areas outside of the residence halls including walkways, entrances, the green, basketball courts, and parking lots.

Smoking Policy

Smoking is allowed on campus only in clearly identified areas.

No Smoking Permitted (Entire perimeter of campus along the canyon, Friendship Lane: Small conference center, Athenaeum, Guest Residence, Security Main Gate House).

Smoking Permitted (Founders Hall: first-floor west patio near benches away from doors, Gandhi and Ikeda: Stairs second landing between two buildings by benches, Pauling Hall: Overlook east of reflection ponds, east and end of Pauling near benches just east of Room 216 A, Student Center: Patio area south of east entry door, the area behind building entrance to the kitchen, Other areas near Ikeda/Student Center: second level walkway area with trees and benches west of the building, Outside Residence halls: No smoking within 25 feet of entrances, including terraces and balconies)

CAMPUS POLICY

Peace Fountain, Lake, and the Ponds

Swimming, jumping and /or pushing others in the water, washing in or throwing trash into the water, tossing coins into the water and bailing water are strictly prohibited.

Pets Policy

No animals are permitted in buildings unless authorized. For regulations pertaining to assistance and service animals, please contact us.

Bicycles, Skates, Skateboards, and Scooters

Rollerblading, roller skating, and skateboarding are not allowed on campus except in designated areas. The only area designated for these activities is the loop road, University Circle, that winds around campus.

Blading, skating, boarding, and scooting are strictly prohibited anywhere else on campus or on the periphery of campus, including sidewalks, parking lots, and along Friendship Lane. Soka bans and prohibits self-balancing scooters, more commonly known as Hover Boards, on the entire campus property. This ban applies to all Hover Boards, self-balancing scooters, battery-operated scooters, and hands-free Segways.

CAMPUS POLICY

Motorized Vehicles

On-campus parking is free with the required parking decal. Parking decals can be obtained through Campus Security. All motorized vehicles including mopeds and motorcycles must be parked, stored, or driven only in the designated areas and not in any campus buildings. Vehicles may park in designated parking spaces on campus.

Parking is not permitted in front of the residence halls and the emergency lane leading to the interior of the residential community and is subject to towing.